

EZ-T SERIES

SUPREME DUTY HOSE REELS

COXREELS® EZ-T Series "Truck Mount" spring driven hose reels are the toughest hose reels in the spring driven line. The extra large chassis with dual pedestal-style arms and Coxreels' Super Hub™ provides triple axle support while reducing vibration and strengthening the structural integrity of the reel. Making it perfect for off-road applications that demand reliability in the most abusive and demanding environments.



Triple axle support with a full frame & Super Hub™

LOW PRESSURE

Models with hose are for air or water service with a maximum temperature 150° F. Models less hose can be used for air, water or oil. **Note: Do not exceed listed hose O.D. to obtain maximum length.**

| HOSE | | | | | | LESS HOSE | | SIZE INDEX |
|--------------------|------|---------|-----|-----|------------|---------------------|------------|------------|
| MODEL | I.D. | O.D. | FT. | PSI | APRX. LBS. | MODEL | APRX. LBS. | |
| EZ-TSH-350 | 3/8" | 5/8" | 50 | 300 | 61 | EZ-TSHL-350 | 55 | 1 |
| EZ-TSH-375 | 3/8" | 5/8" | 75 | 300 | 82 | EZ-TSHL-375 | 73 | 2 |
| EZ-TSH-3100 | 3/8" | 5/8" | 100 | 300 | 85 | EZ-TSHL-3100 | 74 | 2 |
| EZ-TSH-450 | 1/2" | 3/4" | 50 | 300 | 63 | EZ-TSHL-450 | 55 | 1 |
| EZ-TSH-475 | 1/2" | 3/4" | 75 | 300 | 82 | EZ-TSHL-475 | 71 | 2 |
| EZ-TSH-4100 | 1/2" | 3/4" | 100 | 300 | 95 | EZ-TSHL-4100 | 80 | 2 |
| EZ-TSH-535 | 3/4" | 1 1/16" | 35 | 300 | 77 | EZ-TSHL-535 | 67 | 3 |
| EZ-TSH-550 | 3/4" | 1 1/16" | 50 | 300 | 83 | EZ-TSHL-550 | 70 | 3 |

MEDIUM PRESSURE

Reels are furnished with standard one wire braid hose suitable for air, water or oil applications. Hose exceeds SAE R1 specifications. Maximum temperature 250° F. **Note: Do not exceed listed hose O.D. to obtain maximum length.**

| HOSE | | | | | | LESS HOSE | | SIZE INDEX |
|-------------------|------|---------|-----|------|------------|--------------------|------------|------------|
| MODEL | I.D. | O.D. | FT. | PSI | APRX. LBS. | MODEL | APRX. LBS. | |
| EZ-TMP-350 | 3/8" | 1 1/16" | 50 | 3000 | 74 | EZ-TMPL-350 | 61 | 1 |
| EZ-TMP-375 | 3/8" | 1 1/16" | 75 | 3000 | 99 | EZ-TMPL-375 | 80 | 2 |
| EZ-TMP-450 | 1/2" | 1 3/16" | 50 | 2500 | 77 | EZ-TMPL-450 | 64 | 1 |
| EZ-TMP-475 | 1/2" | 1 3/16" | 75 | 2500 | 100 | EZ-TMPL-475 | 80 | 2 |
| EZ-TMP-550 | 3/4" | 1 1/16" | 50 | 1500 | 94 | EZ-TMPL-550 | 74 | 3 |

HIGH PRESSURE

Reels are furnished standard with S.A.E. 100R16 #1 or #2 wire braid hose suitable for grease and hydraulic oil applications. Maximum temp. 250° F. **Note: Do not exceed listed hose O.D. to obtain maximum length.**

| HOSE | | | | | | LESS HOSE | | SIZE INDEX |
|--------------------|------|---------|-----|------|------------|---------------------|------------|------------|
| MODEL | I.D. | O.D. | FT. | PSI | APRX. LBS. | MODEL | APRX. LBS. | |
| EZ-THP-150 | 1/4" | 9/16" | 50 | 5000 | 74 | EZ-THPL-150 | 62 | 1 |
| EZ-THP-175 | 1/4" | 9/16" | 75 | 5000 | 88 | EZ-THPL-175 | 71 | 2 |
| EZ-THP-1100 | 1/4" | 9/16" | 100 | 5000 | 104 | EZ-THPL-1100 | 82 | 2 |
| EZ-THP-350 | 3/8" | 1 1/16" | 50 | 4000 | 78 | EZ-THPL-350 | 66 | 1 |
| EZ-THP-375 | 3/8" | 1 1/16" | 75 | 4000 | 98 | EZ-THPL-375 | 80 | 2 |

REEL DIMENSIONS

Technical Data Sheets Available On Website

| SIZE INDEX | W | H | L | X | Y | M | N |
|------------|--------|---------|---------|----|----|----|----|
| 1 | 9 3/8" | 21 1/4" | 19 1/2" | 8" | 9" | 7" | 8" |
| 2 | 9 3/8" | 25 1/2" | 24" | 8" | 9" | 7" | 8" |
| 3 | 9 7/8" | 25 1/2" | 24" | 8" | 9" | 7" | 8" |

Overall Dimensions — Base — Mounting Pattern

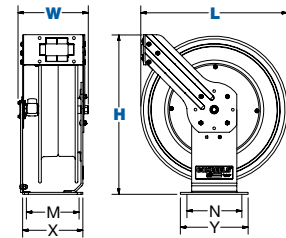

| LET'S COMPARE | Conventional SPRING DRIVEN REELS | EZ-COIL |
|-----------------|----------------------------------|--------------|
| SPEED | 25 ft./sec. | 5 ft./sec. |
| WHIPPING | 5-15 ft. | 1 ft. |
| IMPACT | 500 ft./lbs. | 0-1 ft./lbs. |

Up To 80% Slower Retraction

Based on an independent evaluation performed by COXREELS. Depending on certain conditions, results may vary.

EZ-T SERIES :: REEL SPECIFICATIONS

SWIVEL

- External fluid path with machined from solid brass 90° full-flow NPT swivel inlet (Zinc plated steel swivel on HP models)
- Swivel Seals: NITRILE
- Electroless nickel plated steel swivel on 1" models

DESIGN & STRUCTURE

- Sturdy dual pedestal reel features Coxreels' exclusive Super Hub™ dual axle support system
- Built for rugged mobile applications
- Guide arm adjusts to wall, floor, vehicle & overhead positions
- Stainless Steel rollers on 3/4" & 1" models
- Solid one piece, heavy gauge 1/4" steel base & support posts for maximum strength
- 1" solid steel axle & lubricated precision bearings for smooth rotation

EZ-COIL RETRACTION

- **OUR PATENTED SAFETY SYSTEM THAT RETRACTS UP TO 80% SLOWER THAN CONVENTIONAL SPRING DRIVEN REELS**
- Enclosed factory tuned & matched cartridge-style spring motor
- Non-corrosive stainless steel spring, pawl & zinc plated ratchet
- Multi-position lock ratchet mechanism secures hose at desired length

SIGNATURE FEATURES

- Professional grade heavy duty steel construction
- Durable proprietary CPC™ powder coat process
- Rolled edges & ribbed discs provide strength & safety
- Leading 2-year manufacturer's limited warranty
- Made in the U.S.A. - Sold & Supported Worldwide

POSSIBLE FIELDS OF APPLICATION

- Air/Water Services
- Pneumatic Tools
- Washdown
- Lubrication
- Fuel Delivery
- Chemical Fluid Transfer
- General Industrial
- Manufacturing Plants
- Lube Skids & Trucks
- Service / Mechanic / Utility Vehicles
- Mining, Construction & Railroad Operations
- Automotive, Fleet & Aircraft Maintenance

ACCESSORIZE YOUR REEL :: PG 17

- O-Rings & Swivels
- Mounting Brackets
- Hoses
- Assorted Reel Accessories

